

**PLAN No 1982**  
**FOR THE IMPROVEMENT OF**  
**FORTY-THIRD STREET**

BETWEEN  
**SEPULVEDA AVENUE AND WATERMAN AVENUE**  
 IN THE  
**CITY OF SAN BERNARDINO**  
 CALIFORNIA

OCTOBER 1951

R.D. FORSYTHE  
 City Engineer

PLAN ADOPTED November 2, 1951

**FILED**  
 RECORDED

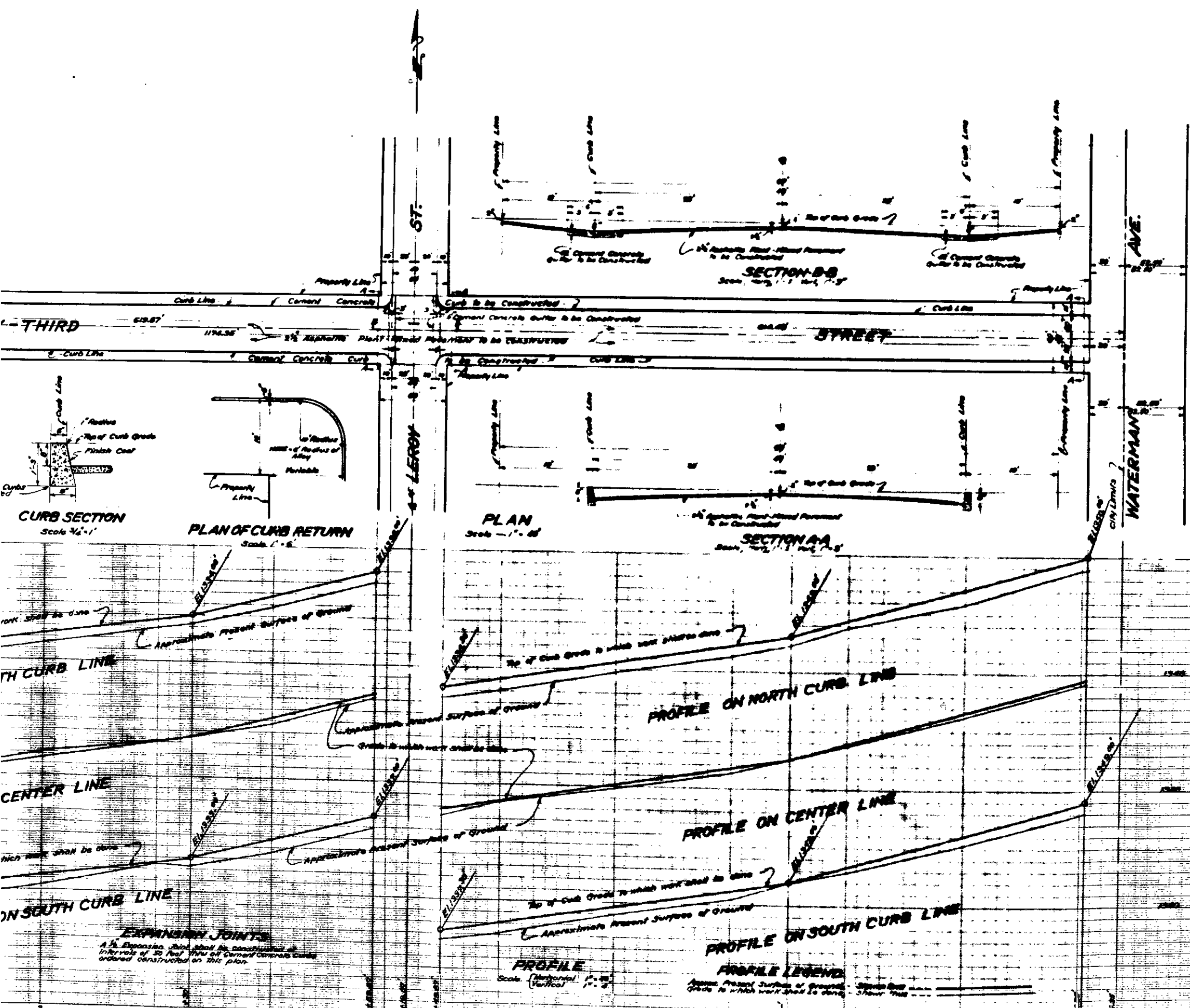

**LEGEND**

- 1" = 1" means feet at right
- 10" = 10" means feet at left
- M means Number
- C means Center Line
- E1 means Elevation
- Cement Concrete Curb to be constructed
- 2 1/2" Asphalt Road Mixed Pavement to be constructed
- 5" Current Concrete Curb to be constructed
- ST means Street
- Ave. means Avenue
- Shown on plan thus [Symbol]
- Shown on plan thus [Symbol] in section thus [Symbol]
- Shown on plan thus [Symbol] in section thus [Symbol]

**TITLE TO STREET**

Forty-Third Street is described by Map of San Bernardino Heights Tract No 1338 recorded in Book 26 of Maps of Page 58 records of San Bernardino County.

**GRADE ORDINANCE**

Grade of FORTY-THIRD STREET established by Resolution No 233 of the City of San Bernardino.

**DATUM**

All Elevations shown in this plan are in feet and are above datum which is 1048.86 below the City Bench Mark as established by Ordinance No 305 of the City of San Bernardino, California.

**PLAN No 1982**  
**FOR THE IMPROVEMENT OF**  
**FORTY-THIRD STREET**

BETWEEN  
**SEPULVEDA AVENUE AND WATERMAN AVENUE**  
 IN THE  
**CITY OF SAN BERNARDINO**  
 CALIFORNIA

OCTOBER 1951

R.D. FORSTYHE  
 City Engineer

PLAN ADOPTED - November 2, 1951

**FILED**  
 RECORDED

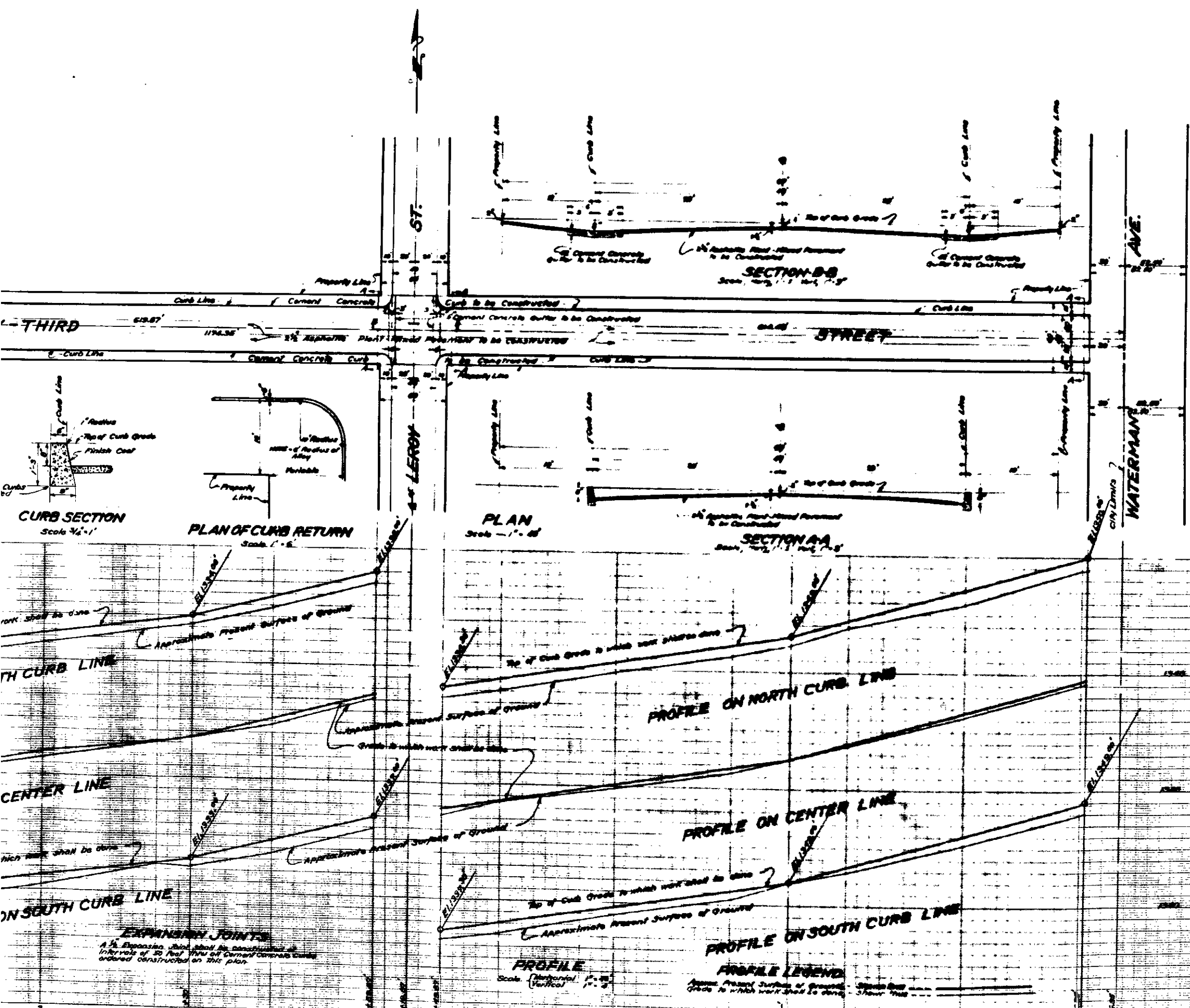

**LEGEND**

- 1" = 1" means feet at right
- 10" = 10" means feet at left
- M# means Number
- C# means Center Line
- E# means Elevation
- C# means Center Line
- 2# means Elevation
- 5# means Elevation
- 6# means Elevation
- 7# means Elevation
- 8# means Elevation
- 9# means Elevation
- 10# means Elevation
- 11# means Elevation
- 12# means Elevation
- 13# means Elevation
- 14# means Elevation
- 15# means Elevation
- 16# means Elevation
- 17# means Elevation
- 18# means Elevation
- 19# means Elevation
- 20# means Elevation
- 21# means Elevation
- 22# means Elevation
- 23# means Elevation
- 24# means Elevation
- 25# means Elevation
- 26# means Elevation
- 27# means Elevation
- 28# means Elevation
- 29# means Elevation
- 30# means Elevation
- 31# means Elevation
- 32# means Elevation
- 33# means Elevation
- 34# means Elevation
- 35# means Elevation
- 36# means Elevation
- 37# means Elevation
- 38# means Elevation
- 39# means Elevation
- 40# means Elevation
- 41# means Elevation
- 42# means Elevation
- 43# means Elevation
- 44# means Elevation
- 45# means Elevation
- 46# means Elevation
- 47# means Elevation
- 48# means Elevation
- 49# means Elevation
- 50# means Elevation

**TITLE TO STREET**

Forty-Third Street is dedicated by Map of San Bernardino Heights Tract No 1338 recorded in Book 26 of Maps of Page 58 records of San Bernardino County.

**GRADE ORDINANCE**

Grade of FORTY-THIRD STREET established by Resolution No 233 of the City of San Bernardino.

**DATUM**

All Elevations shown in this plan are in feet and are above a datum which is 1048.82 below the City Bench Mark as established by Ordinance No 305 of the City of San Bernardino, California.